

Features and specifications

- Mechanical stroke adjustment
- Standard construction, square head, tie rod design
- Provision for smaller as well as bigger rod diameter for each bore size
- Bore sizes : 40mm to 160mm
- Strokes available in any practical stroke length
- Maximum working pressure : 160 bar
- Piston rods : 18mm to 110mm
- Non-cushioned
- Temperature range - 20°C to 80°C (standard)
- 20°C to +150°C (optional)
- Standard fluid : Mineral oil, DIN 51524 (HL, HLP)
- Seals types to suit a wide variety of operating environments

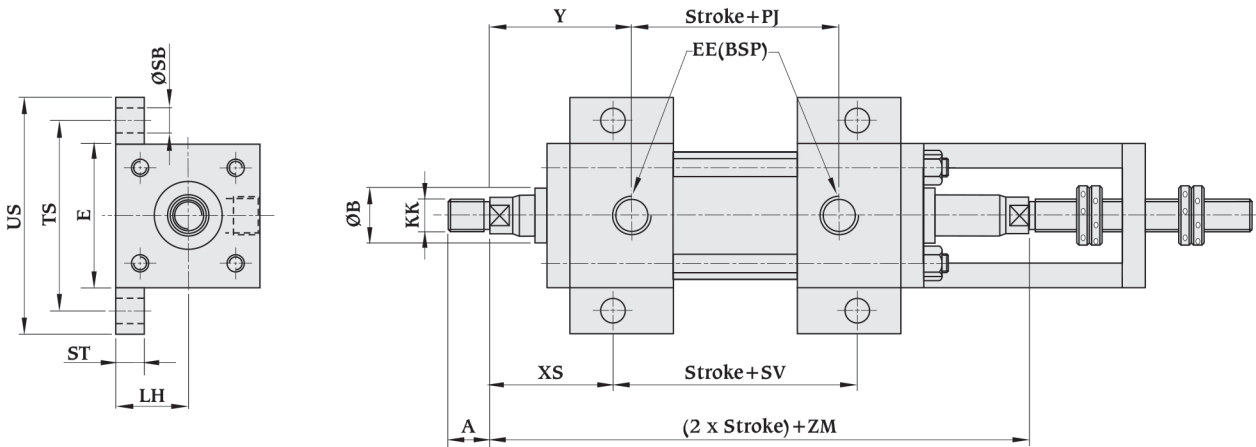

Piston dia	Rod dia	A	KK	ØB	EE	Y	PJ	E	LH	ØSB	ST	SV	TS	US	XC	ZM			
40	18	25	18 28	M14x1.5P	M20x1.5P	40	40	1/4"	66	66	63	31.5	11	13	105	83	104	56	218
50	25	35	28 36	M20x1.5P	M27x2P	40	55	1/4"	66	66	75	37.5	14	19	110	102	127	56	223
63	35	45	36 45	M27x2P	M39x2P	55	65	3/8"	67.5	67.5	90	45	18	26	114	124	161	58	230
80	45	56	45 56	M39x2P	M42x2P	65	72	1/2"	75.6	75.6	115	57.5	18	26	123	149	186	64.6	252
100	45	70	45 63	M39x2P	M56x2P	65	90	3/4"	104	104	130	65	21	32	142	172	216	91	323
125	56	90	56 85	M42x2P	M76x2P	72	108	3/4"	103	103	165	82.5	26	32	157	210	254	89	336
160	70	110	63 95	M56x2P	M95x2P	-	-	1"	115	115	205	102.5	33	38	165	260	318	96	365

Ordering details of AJ series hydraulic cylinders

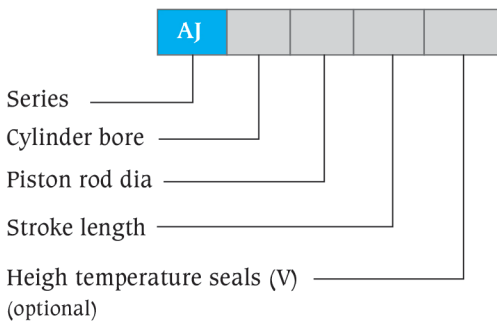

Example

AJ series hydraulic cylinder with bore 80mm, piston rod dia 45mm, stroke 50mm will be specified as

AJ	80	45	50	
----	----	----	----	--

All dimensions are in millimeters unless otherwise stated.