

Stroke Adjustable Air Cylinders

Basic Dimensions

Model - Economy

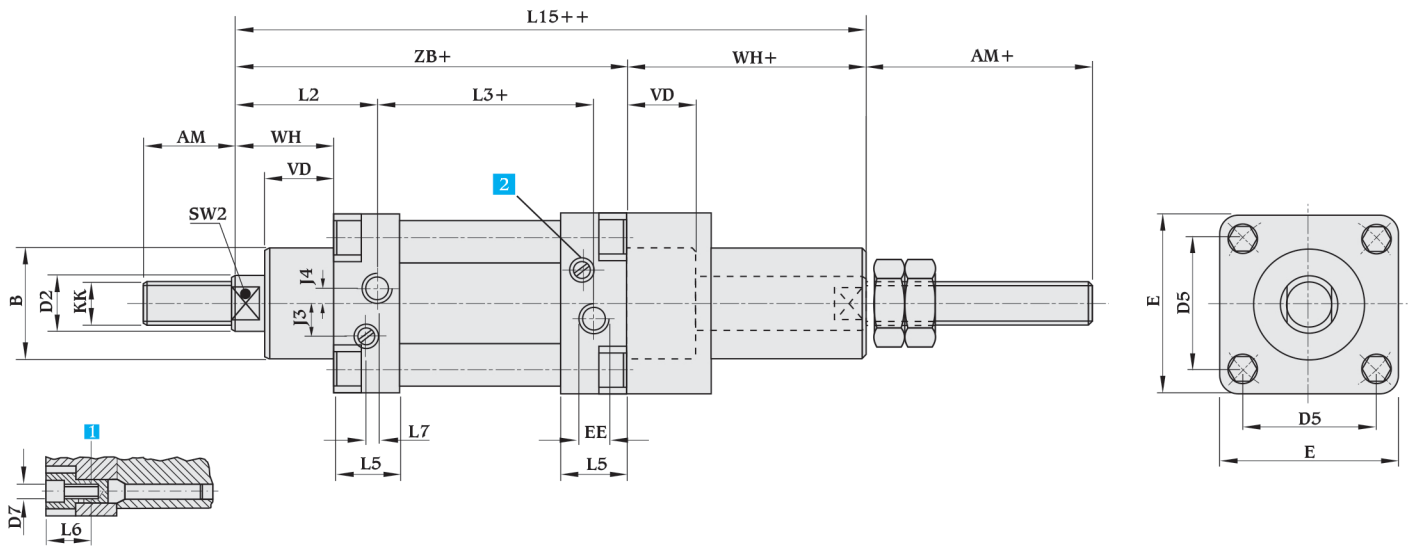

- 1** Internal Hexagon Head Screw with internal thread
- 2** Adjusting Screw for adjustable limit damping
- + = Plus length of stroke
- ++ = Plus 2 x stroke length

All dimensions in mm unless otherwise specified

Bore size	AM	B ∅ f8	D2 ∅ f8	D5	D7	E	EE BSP	J3	J4	KK THD'S	L2	L3	L5	L6	L7	SW2	VD	WH	ZB	L15
32	22	30	12	32.5	M 5	45	G1/8"	7.0	-	M 10 x 1.25	35.0	76	26.0	15	9.5	10	16	26	120	146
40	24	35	16	39.6	M 5	54	G1/4"	9.6	4.5	M12 x 1.25	43.0	79	26.0	15	3.0	13	20	30	135	165
50	32	40	20	48.0	M 8	65	G1/4"	12.0	5.5	M 16 x 1.5	49.0	82	24.0	14	4.0	17	25	37	142	179
63	32	42	20	59.4	M 8	80	G3/8"	13.0	11.5	M 16 x 1.5	54.0	87	28.5	14	-	17	28	40	155	195
80	40	48	25	70.7	M 8	96	G3/8"	17.0	16.0	M 20 x 1.5	63.0	96	27.0	17	-	22	34	49	171	220
100	40	52	25	93.3	M 8	126	G1/2"	17.5	16.0	M 20 x 1.5	69.5	101	32.5	17	-	22	40	53	187	240

Note : Subject to change without prior notice

