

**DIMENSIONS:**

W = Width of enclosure 300mm to 1000mm.  
w1= Widthwise clearpass (W-58).  
w2= C plate width (W-70).  
w3= Width of gland plate (W-100).  
w4= Mounting hole CC widthwise (W+60).  
w5= Usable area on door for cutouts (W-178).  
D = Depth of the enclosure 150mm to 600mm.  
d1= Opening for glands at bottom (D-153).  
d2= C plate distance from door (D-23).  
H = Height of the enclosure 300mm to 1200mm.  
h1= Heightwise clearpass (H-58).  
h2= C plate height (H-70).  
h3= Mounting hole CC heightwise (h-50).  
h4= Usable area on door for cutouts (H-141).

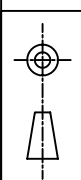

1	2	3	4	5	6	7	8
DESCRIPTION : Single body.			CUSTOMER :			DRAWING No. : EE-SB/WM-GA-0003	
DETAILS : Internal Details.			DRAWING No. : EE-SB/WM-GA-0003			CHKD : BSS	
EXCEL ENCLOSURES, PUNE. (excelenclosures@yahoo.co.in), 020-726 0048.			DRAWING No. : EE-SB/WM-GA-0003			APPRVD :	
FRONT VIEW			R.H.S.VIEW			SHEET : 07 OF 08	
W			D			REV : 00	
h3			h1			DATE : 26/09/02	
w5			h2				
h4			d1				
10			d2				
w1			H				
w2							
w3							
w4							
TOP VIEW							