



## INCO ENTERPRISES

Shop No.1, Vadagama House, 25, 3rd Panjrapole Lane, Near Gulal Wadi Circle, Mumbai - 400 004, INDIA.

Mob 9821048955/ 9820191267

Tel - 66394118 / 67436649 Fax - 2384 0535

E-mail - [incosteel@vsnl.net](mailto:incosteel@vsnl.net)

E-mail - [rakesh@incoenterprises.com](mailto:rakesh@incoenterprises.com)

E-mail - [rajesh@incoenterprises.com](mailto:rajesh@incoenterprises.com)

[www.incoenterprises.com](http://www.incoenterprises.com)



CLAMPS FOR DRY CLADDING

BRACKETS FOR GLASS GLAZING  
& ACP CLADDING

NUT BOLTS & SCREWS

ANCHOR FASTENERS

RAILING WORKS



INCO ENTERPRISES

# Corporate

## Be Visible

INCO steel Enterprises in the business of Stainless Steel Fasteners for past 20 years. Our products are ISO certified and made as per Customer specifications. With our modern equipments, workshop facility and dedicated work force; we are able to meet customers' demand on time every time.

## Be In Mind,

Highest quality of products & Prompt delivery are always been priority at INCO. We have integrated manufacturing for critical fasteners with ability to supply small / medium / large batch of quantities of standard / tailor made. With our network across India and automated packaging facility we are in a position to offer timely deliveries across India.

## Be In Business

Our experience has resulted in developing of various products used by Architects, Railways, Major Electricity Boards, Consumer Industries, Home Appliances, Electronic Industries etc.

# Products

Clamps for Granite Dry Cladding  
Bracket for Glass ACP Cladding Facade work  
Nut Bolts, Screws & Anchor Fasteners

- Self drilling screws & self tapping
- Allen head grub screw
- Hex/ Square/ Fly/ Slotted bolts & screws
- Square/ Countersunk/ Flat machine screws
- Threaded Spindle/ Pins/ Screws
- Threaded clamps
- Wood screws

## Anchor Fasteners

- Rawal anchor for brake wall
- Thru bolt for RCC

## Railing Works in Stainless Steel

## Other Products

- Full threaded bars
- Full threaded studs



# Infrastructure



We have a well-equipped quality control unit with the latest machinery to meet the industry standards. The sophisticated machinery allows us to meet the bulk requirements of the clients. The machines are operated by a proficient technical staff comprising of qualified technicians and engineers.

# Anchor Fasteners



## DESCRIPTION

- Suitable to use in concrete to medium to heavy load
- The one-piece clip is formed around Anchor, assuring full expansion for dependable, superior holding power
- Expanding clip will not fall off or twist in the hole
- Fast and efficient through fixing Economical for wide range of fastening application
- Ideal for pipe suspension, foundation work, Aluminium glazing system, window support systems
- Available in Galvanized steel, Stainless Steel A2/ 304 & A4/ 316 Material

The test values listed below were obtained using 200-250kgs/cm concrete (M20-M25). A safe working load should not exceed 25% of stated values.

| Sr No. | Anchor Size | Threading Length (mm) | Max. Fixture thickness (mm) | Drill hole Dia x depth (mm) | Setting Depth (mm) | Pull out Load (Kgs) |
|--------|-------------|-----------------------|-----------------------------|-----------------------------|--------------------|---------------------|
| 1      | M8 x 75     | 28                    | 15                          | 8x60                        | 50                 | 800                 |
| 2      | M8 x 100    | 32                    | 40                          | 8x60                        | 50                 | 800                 |
| 3      | M10 x 75    | 28                    | 10                          | 10x60                       | (50)               | 1000                |
| 4      | M10 x 100   | 32                    | 20                          | 10x70                       | 60                 | 1200                |
| 5      | M10 x 125   | 36                    | 40                          | 10x70                       | 60                 | 1200                |
| 6      | M10 x 150   | 36                    | 65                          | 10x70                       | 60                 | 1200                |
| 7      | M12 x 75    | 28                    | 5                           | 12x60                       | (50)               | 1200                |
| 8      | M12 x 100   | 32                    | 10                          | 12x80                       | (70)               | 1500                |
| 9      | M12 x 125   | 36                    | 30                          | 12x90                       | 80                 | 1700                |
| 10     | M12 x 150   | 36                    | 55                          | 12x90                       | 80                 | 1700                |
| 11     | M16 x 100   | 40                    | 15                          | 16x90                       | (80)               | 2300                |
| 12     | M16 x 150   | 50                    | 20                          | 16x110                      | 100                | 2800                |
| 13     | M16 x 180   | 50                    | 50                          | 16x110                      | 100                | 2800                |
| 14     | M16 x 200   | 50                    | 70                          | 16x110                      | 100                | 2800                |
| 15     | M20 x 150   | 50                    | 15                          | 20x110                      | 100                | 3500                |
| 16     | M20 x 180   | 50                    | 45                          | 20x110                      | 100                | 3500                |
| 17     | M20 x 200   | 50                    | 80                          | 20x110                      | 100                | 3500                |



## STRUCTURAL BOLTS: Heavy Hex, Tension Control, Heavy Hex Nuts & Washers

- ASTM A325 Type I Standard
- ASTM A325 Type III Weathering
- ASTM A490 150,000 Min. Tensile
- A449 Gr. 5
- Heavy Hex Head, Button Head Shear and Slotted Countersunk Bolts
- 1/2" Through 1 1/2" in Diameter
- Specials, made to customer's drawings
- Standard and Special Lengths Available
- In Stock in Our Warehouse
- Plain, Hot Dip Galvanized or Mechanical Galvanized
- A563 Gr. DH, Gr. A, A194 Gr. 2H Heavy Hex Nuts
- Direct Tension Indicator Washers ASTM F959
- Electric Wrenches for Shear Bolts and Heavy Hex Bolts
- Sales, Repairs and Replacement Parts for Wrenches
- Job site Bolt Tension Calibration Inspections
- In House Rotational Capacity Testing
- Complete Mill Traceability and Certification Available
- F436 Heavy Structural Washers

# Bracket and Clamps



INCO 01



INCO 02



INCO 06



INCO 07



INCO 03

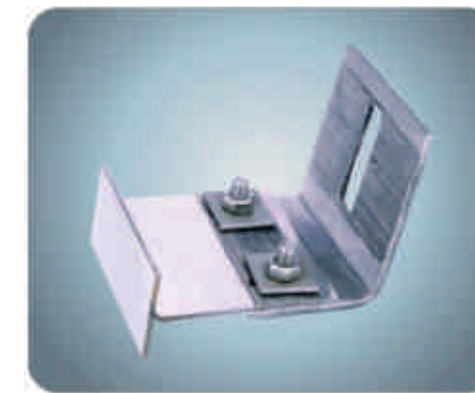

INCO 08



INCO 09



INCO 04



INCO 10

- Bracket and Clamps made in M.S. & Stainless Steel
- M.S. Brackets Hot Dip Galvanized / Painted
- Stainless Steel Brackets & Clamps in 304, 316 grades with Brush and Glossy finish
- Dry Cladding Clamps in Standard & Customized sizes are available



INCO 05



INCO 11



INCO 12

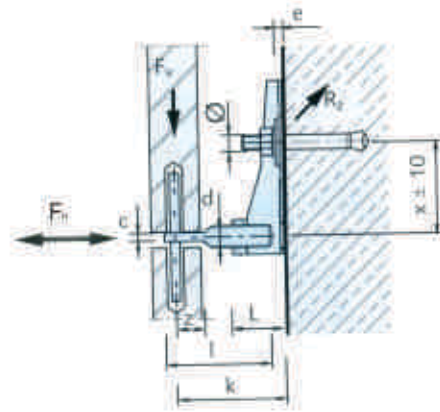
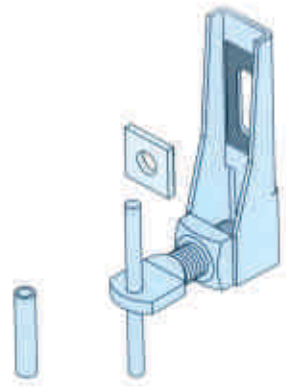

The Inco Anchor has been designed for short projections of 60 mm to 120 mm and large loads up to 1300 N. It consists of a rugged base body, a toothed washer and a threaded spade bolt.



# Applications

