



EUREKA

ISO 9001:2015, ISO 14001:2015, ISO 45001:2018, ISO 17025:2017: NABL Certified Company



EUBAR



**EUREKA
INDUSTRIAL
EQUIPMENTS
PVT. LTD.**

REGD. & SALES OFFICE : 17-20, 1st Floor, Royal Chambers, Paud Road, Pune - 411 038, Maharashtra, India.

■ Tel: 0091-20-25443079,25461315 ■ sales@eurekaflow.com

FACTORY : 501, 'J' Block, M.I.D.C., Pimpri, Pune - 411018.

■ Email: works@eurekaflow.com

MUMBAI OFFICE : Office No.116, Growmore Tower, 1stFloor, Plot No.5, Sector No.2, Kharghar, Navi Mumbai - 410 210 ■ Mobile: 9322598274

www.eurekaflow.com

EUBAR

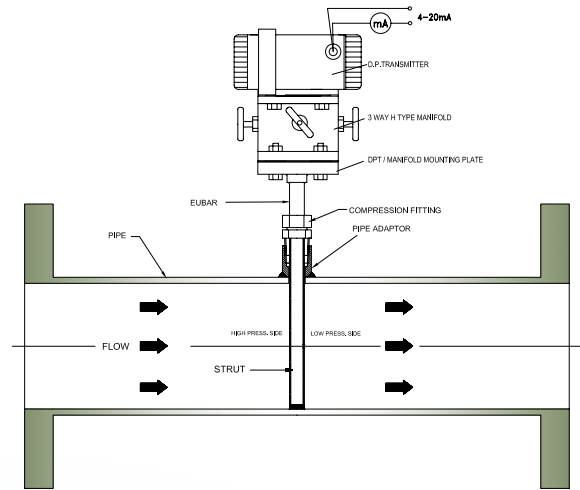
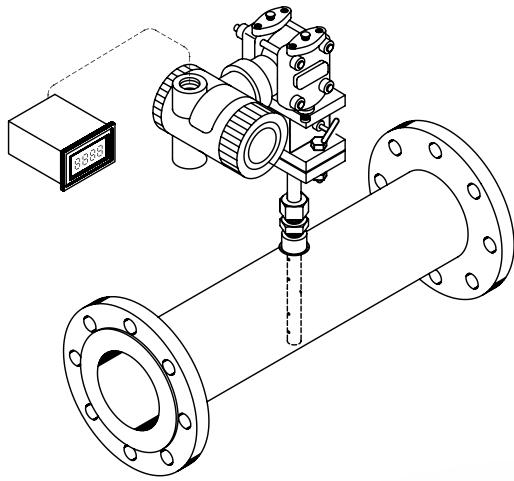

Principle & Working

- Eureka make EUBAR is based on principle of Pitot Tube.
- The basic principle is to locate upstream total pressure ports along a strut that spans the pipe. These total pressure measuring points are positioned at the defining area averaging locations.
- The measuring static ports are positioned downstream at a location selected by manufacturer to give optimum performance.
- The averaged total pressure and the flowing low pressure are transmitted to the D.P. transmitter.

Styles Available

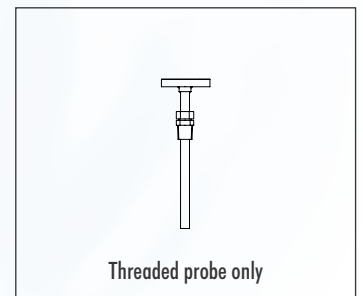
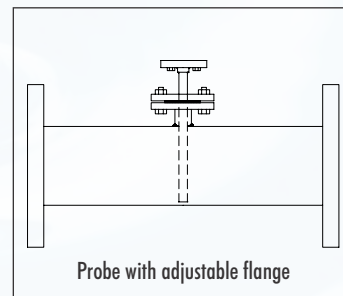
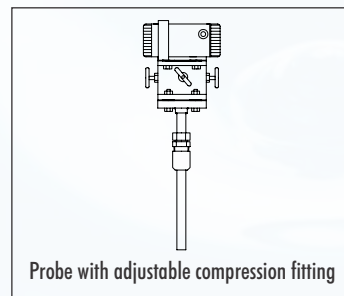
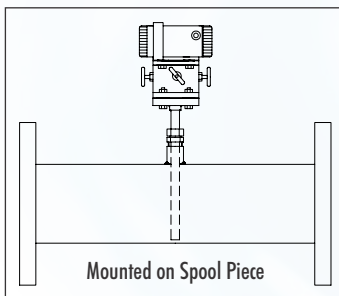

Specifications

Available for Pipe size: 3"NB to 16"NB (Higher sizes on request)

Material of Construction: 304 SS, 316 SS, M.S., Hastelloy-C Other material on request

Mounting Style Available

Screwed, Compression Fitting, Flanges or with Spool Piece, Retractable Version

Application:

Liquid and gases
 Low pressure liquids
 Water through big pipes
 Measurement of gases flowing through ducts
 Blower flow measurement

Data Required:

Name of the medium
 Operating pressure & temperature
 Density & Viscosity at operating condition
 Internal diameter of the pipe
 Flow